

## PHOTOTRANSISTOR SENSOR SOLID STATE PHOTOCONTROLS

**“Optimum Performance Without Operational Drift”**

### DESCRIPTION

**P Series** electronic photocontrols utilize a phototransistor light sensor. The photo sensor holds its original operating parameters throughout its life. It is not susceptible to operational “drift” caused by cadmium sulfide breakdown caused by harsh environments or breakdown caused by over heating ( a condition of AC electro-mechanical designs). Extended life is achieved through a non-chatter load break from a low power consumption DC circuit.

### FEATURES

- Meets or exceeds ANSI C136.10.
- Proven DC circuit design.
- Close 1:1.5 On to Off operating ratio.
- Non-chatter load break
- Electronic phototransistor light sensor maintains operational levels throughout its life.
- Heavy duty construction.

### BENEFITS

- 12 year expected life.
- Low power consumption and extended life from “cool” operating DC circuit.
- Close ratio reduces burning hours at sunrise.
- Reduced burning from consistent operating levels throughout its life.
- Significantly reduced energy costs.
- Significantly reduced maintenance costs.

### MECHANICAL SPECIFICATIONS

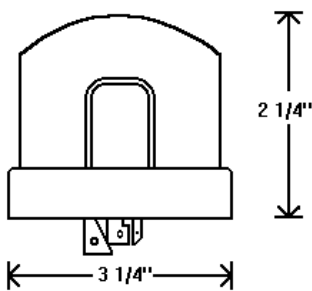

<b>Housing:</b>	UV stabilized, impact resistant polypropylene.
<b>Base:</b>	High temperature ABS.
<b>Contact Blades:</b>	Solid brass, three prong, locking type.
<b>Gasket:</b>	Cross linked polyethylene.
<b>Packaging:</b>	Individual units are sealed in water resistant plastic.
<b>Weight:</b>	3.0 oz. each, 20 lbs. per 100 unit carton.
<b>Size:</b>	16” x 16” x 12” per 100 unit carton.

**Warranty: 6 Year 1 for 1 replacement warranty.**

# P-Series

## PHOTOTRANSISTOR SENSOR SOLID STATE PHOTOCONTROLS

### OPERATING SPECIFICATIONS

#### Operating Voltage:

Model	Voltage	Color
P120	105 - 130	Gray
P124	105 - 305	Blue
P240	195 - 305	Maroon
P480	420 - 530	Yellow

#### Load Rating:

1000 Watt tungsten, 1800 VA

#### Life at rated load:

5,000 Operations (13.7 Years)

#### Power Consumption:

1.0 watts average @ 120 volts

1.6 watts average @ 208 volts

1.9 watts average @ 240 volts

2.1 watts average @ 277 volts

#### Moisture Resistance:

100% RH.

### CROSS REFERENCE

Sun - Tech	Dark to Light
PX120	DP120
PX124	DP124
PX240	DP240
PX480	DP480

### ORDERING INFORMATION

**P120 - 1.0 - P T M BR**

Model #	Turn-On	Photosensor	Time Delay	Surge Protection	Color
<b>P120*</b> (105 - 130V) <b>P124</b> (105 - 305V) <b>P240</b> (195 - 305V) <b>P480</b> (420 - 530V)	<b>1.0</b> fcs. On <b>1.5</b> fcs. On <b>2.0</b> fcs. On <b>2.5</b> fcs. On	<b>P</b> Phototransistor	<b>_</b> No Delay ** <b>T</b> 3-5 Sec. Delay	<b>_</b> 90J MOV ** <b>M</b> 160J MOV <b>Y</b> 2 160J MOVs <b>W</b> 320 J MOV	<b>_</b> Per ANSI ** <b>BR</b> Brown <b>BK</b> Black

PX - standard grade electronics  
PEX - filtered phototransistor

\*\*No Letter



 **Sun - Tech**  
Sunrise Technologies - Affiliate of Electro Switch Corp.

Sunrise Technologies • 54 Commercial St. • Raynham, MA 02767

Phone: (508) 821-1597 • Fax: (508) 822-0593 • E-mail: info@sun-tech.biz • www.sun-tech.biz