

CADMIUM SULFIDE SENSOR SOLID STATE PHOTOCONTROLS

“Optimum Performance with Human Eye Response”

DESCRIPTION

S Series electronic photocontrols have a spectral response that mirrors that of the human eye. Tight On /Off ratios and a cadmium sulfide sensor with minimal sensitivity to invisible light (ultra-violet & infra-red) provide energy savings from minimal burning hours. **S Series** units have extended life due to non-chatter operation at load break and having the cadmium sulfide sensor operate in a low voltage DC electronic circuit.

FEATURES

- Meets or exceeds ANSI C136.10.
- Proven DC circuit design.
- Close 1:1.5 on to off operating ratio.
- Non-chatter load break.
- Light level sensing with a spectral response similar to visible light (not sensitive to UV & IR).
- Heavy duty construction.

BENEFITS

- 12 year expected life.
- Low power consumption and extended life from “cool” operating DC circuit.
- Close ratio reduces burning hours at sunrise.
- Reduced burning with minimal affect of UV & IR.
- Significantly reduced energy costs.
- Significantly reduced maintenance costs.

MECHANICAL SPECIFICATIONS

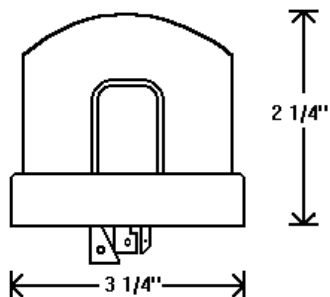

Housing:	UV stabilized, impact resistant polypropylene.
Base:	High temperature ABS.
Contact Blades:	Solid brass, three prong, locking type.
Gasket:	Cross linked polyethylene.
Packaging:	Individual units are sealed in water resistant plastic.
Weight:	3.0 oz. each, 20 lbs. per 100 unit carton.
Size:	16” x 16” x 12” per 100 unit carton.

Warranty: 6 Year 1 for 1 replacement warranty.

S-Series

CADMIUM SULFIDE SENSOR SOLID STATE PHOTOCONTROLS

OPERATING SPECIFICATIONS

Operating Voltage:

Model	Voltage	Color
S120	105 - 130	Gray
S124	105 - 305	Blue
S240	195 - 305	Maroon
S480	420 - 530	Yellow

Load Rating:

1000 Watt tungsten, 1800 VA

Life at rated load:

5,000 Operations (13.7 Years)

Power Consumption:

1.0 watts average @ 120 volts

1.6 watts average @ 208 volts

1.9 watts average @ 240 volts

2.1 watts average @ 277 volts

Moisture Resistance:

100% RH.

CROSS REFERENCE

Sun - Tech	Dark to Light
SX120	D120
SX124	D124
SX240	D240
SX480	D480

ORDERING INFORMATION

S120 - 1.0 - S T M BR

Model #	Turn-On	Photosensor	Time Delay	Surge Protection	Color
S120* (105 - 130V) S124 (105 - 305V) S240 (195 - 305V) S480 (420 - 530V)	1.0 fcs. On 1.5 fcs. On 2.0 fcs. On 2.5 fcs. On	S Standard Cell E Encapsulated	No Delay ** T 3-5 Sec. Delay	90J MOV ** M 160J MOV Y 2 160J MOVs W 320 J MOV	Per ANSI ** BR Brown BK Black

**No Letter

SX - standard grade electronics



 **Sun - Tech**
Sunrise Technologies - Affiliate of Electro Switch Corp.

Sunrise Technologies • 54 Commercial St. • Raynham, MA 02767

Phone: (508) 821-1597 • Fax: (508) 822-0593 • E-mail: info@sun-tech.biz • www.sun-tech.biz