

UTILITY PRODUCTS

Shorting Cap/Open Cap

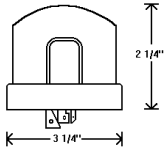

Model #: 5560-OC (Open Cap), 5560-SC (Shorting Cap).
105 - 550 VAC.
Color: Black.

Fail-Off Twistlock Photocontrol

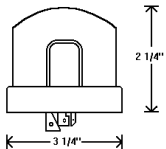

Model #: 5560-FO.
105 - 130 VAC, 1,000W/1,800VA.
Fail Off Design.

FAA Twistlock Photocontrol

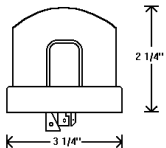

Model #: 5560-FAA.
105 - 130 VAC, 1,000W/1,800VA.
Meets FAA Requirements.
Turn-on level: 35 fc., Turn-off level: 50 fcs.

GE Astrodome Replacement Photocontrol

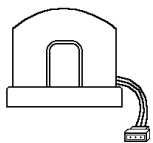

Model #: 5841 (105 - 130 VAC), 5842 (105 - 305 VAC)
1,000W/1,800VA.

Direct Wire-in Photocontrol

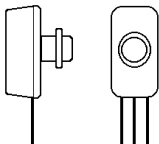

Model #: SA105.
105 - 130 VAC, 1,000W/1,800VA.

Mounting Bracket

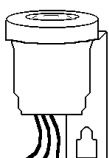

Model #: S476.
105 - 550 VAC.
Bracket or Conduit Mounting.

STANDARD TERMS & CONDITIONS

Prices	Prices are valid for 30 (thirty) days from the date of quotation.
Terms	Net 30 (thirty) days.
Freight	Freight is prepaid and allowed on shipments of 1,400 units or more. Add \$.10 per unit for shipping and handling of smaller purchases.
Standard Packaging	Standard carton size is 100 units. Add \$5.00 broken carton charge for smaller purchases. Individual units are packaged in water resistant plastic.
Minimum Order	Standard minimum order is 1 carton (100 units). Add \$5.00 for orders less than 100 units.
Material Returns	Any returns must have a factory issued RGA number. Returns must be shipped prepaid with an approved carrier, freight collect shipments will not be accepted. Sun-Tech will balance freight costs with equal value of replacement units.
Warranty	<p>Standard warranty of Sun-Tech products is 2 years. Individual product series warranties are as stated on the individual data sheets. The warranty is 1 for 1 replacement for units with factory defects. Units ordered improperly will be accepted, possibly with a negotiated restocking charge. This warranty covers factory defects and does not apply to units abused, vandalized, installed on the incorrect voltage, damaged by faulty luminaires, or direct hits by lightning. Sun-Tech assumes no further liability in the use of the products. This warranty is in lieu of any other warranties expressed or implied.</p> <p>It can be expected that Sun-Tech and its management will stand behind the performance of its product and treat its users as partners in its success.</p>

